

"A" TYPE

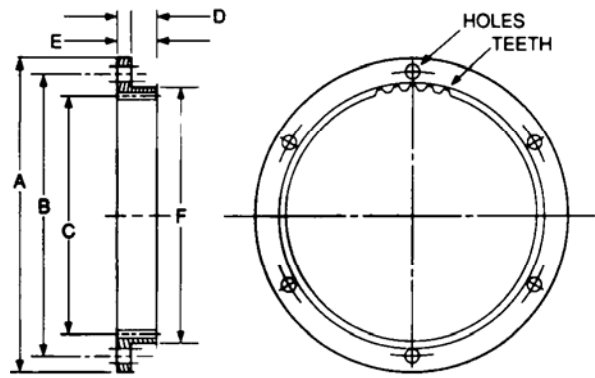

"B" TYPE

DRIVING RING DETAILS

KRAFT Clutch #	Driving Ring #	Driving Ring Type	A	B	C (Nominal)	D	E	F	Holes		Teeth #	Approx Net Weight lb/kg
									#	Size		
KC106	K6939	A	8-1/2 (215.9)	7-7/8 (200.0)	7 (177.8)	5/8 (15.8)	—	—	6	21/64 (8.33)	42	2-3/4 (1.25)
KC107	K6661	A	9-1/2 (241.3)	8-3/4 (222.25)	7-13/16 (198.4)	5/8 (15.8)	—	—	8	21/64 (8.33)	47	3-3/8 (1.53)
KC108	K5805A	A	1 3/8 (263.5)	9-5/8 (244.5)	8-1/2 (215.9)	5/8 (15.8)	—	—	6	13/32 (10.3)	51	4-1/4 (1.93)
KC110	K6187E	A	12-3/8 (314.3)	11-5/8 (295.3)	10-1/2 (266.7)	7/8 (22.2)	—	—	8	13/32 (10.3)	63	7 (3.17)
KC111 & KP111	K6625A (Cast)	A	13-7/8 (352.4)	13-1/8 (333.4)	12 (304.8)	7/8 (22.2)	—	—	8	13/32 (10.3)	72	8 (3.62)
KC111 & KP111	K6625D (Ductile)	A	13-7/8 (352.4)	13-1/8 (333.4)	12 (304.8)	7/8 (22.2)	—	—	8	13/32 (10.3)	72	8 (3.62)
KP211	K6931 (Cast)	A	13-7/8 (352.4)	13-1/8 (333.4)	12 (304.8)	1-7/8 (47.6)	—	—	8	13/32 (10.3)	72	18 (8.16)
KP211	K6931T (Ductile)	A	13-7/8 (352.4)	13-1/8 (333.4)	12 (304.8)	1-7/8 (47.6)	—	—	8	13/32 (10.3)	72	18 (8.16)
KP114	K5712B	B	18-3/8 (466.7)	17-1/4 (438.1)	14-3/4 (374.6)	1-1/8 (28.6)	1/2 (12.7)	16 (406.4)	8	17/32 (13.5)	59	16-1/2 (7.48)
KP214	K5713D	B	18-3/8 (466.7)	17-1/4 (438.1)	14-3/4 (374.6)	2-3/8 (60.33)	1/2 (12.7)	16 (406.4)	8	17/32 (13.5)	59	25-3/4 (11.67)
KP314	KA6518A	B	18-3/8 (466.7)	17-1/4 (438.1)	14-3/4 (374.6)	3-3/8 (85.73)	1/2 (12.7)	16 (406.4)	8	17/32 (13.5)	59	32-5/8 (14.78)

Note: Figures in () are in mm